

ELEPHANT
Gypsum Board

Elephant
Flex **BOARD**

Bendable Gypsum Board



Ultimate **SHAPE** for your **Imagination**



Bendable Gypsum Board

Elephant FlexBOARD

FlexBOARD is a gypsum board with thickness of 6 mm. The special fiber putting in the board helps to increase strenght and bending capability together with the special white sticky paper pressed into the board, FlexBOARD is very suitable for all bending work.

Properties



Narrow Curve Radius from 450 to 4000 mm



Fast & Easy Bending without any use of water and other helping equipment.



Seamless Joint Coating as regular gypsum board

Recommended Usage Areas

Elephant FlexBOARD is suitable for curved ceiling, curved partition and indoor usage which need luxury beautiful decoration and gimmick for the design.

- Dome Ceiling or Step Ceiling with curved design.
- Curved partition or pole covering to avoid a right angle and makes the area more creative in curved design.

Product Info



Size	1200 x 2400 mm
Thickness	6 mm
Edge	Tapered

Gypsum board bending methods

Dry Bending

easy, fast and durable. FlexBOARD was designed to be bended without using water.

- Bend it directly on the frame.
- Use Black screw to fix Gypsum Board and frame together and cover joint with Easy Joint Compound.

Wet Bending

a regular and easy way to bend gypsum board to curved shape by using wet cloth or roller to apply a water to the side of the board that you want to bend with desired radius and leave it for about 10 minuits. In case of convex bending, apply water to the back side of the board. For concave bending, apply water to the front side of the board. (Avoid applying water to the edge of the board because the water will cause the edge to be soften when screw in)



Bendable Gypsum Board

Elephant FlexBOARD

The characteristic comparison between Elephant FlexBOARD and Plywood Sheet

Elephant FlexBOARD	Plywood Sheet
<ul style="list-style-type: none"> • Can be bended in the most narrow curve radius, strong and durable. • Tapered edge, easy to install and coat the joint. • Smooth surface, can paint right away after installation. • Can be installed together with regular gypsum partition system 	<ul style="list-style-type: none"> • Very thin, not strong enough. • Cannot coat the joints to make it look like the same sheet. • Surface is not smooth, consume more time on coating and decorating. • Not safe due to its combustibility. • Installation need to be adjusted if use together with regular gypsum partition system.

* Compared with regular plywood using in bending work, estimating 3 mm thickness

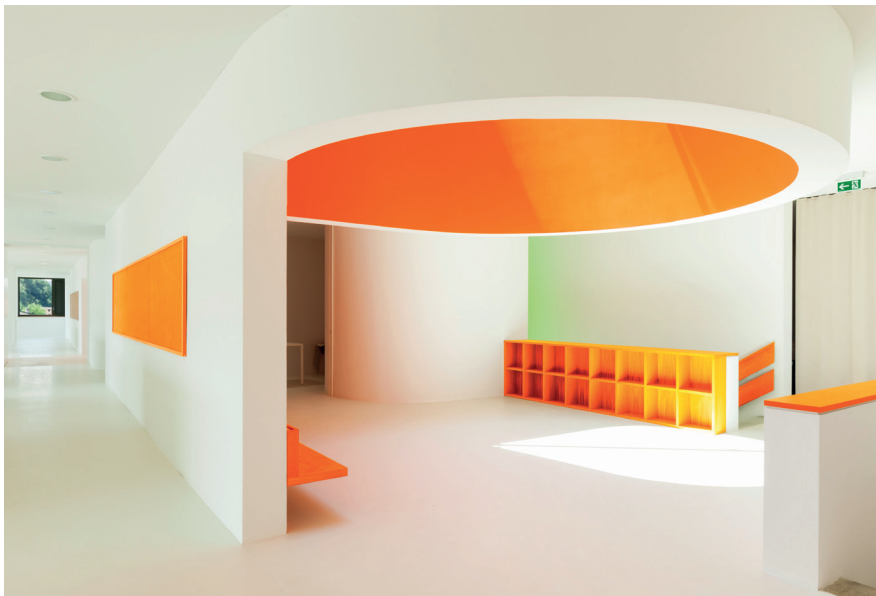

Installation

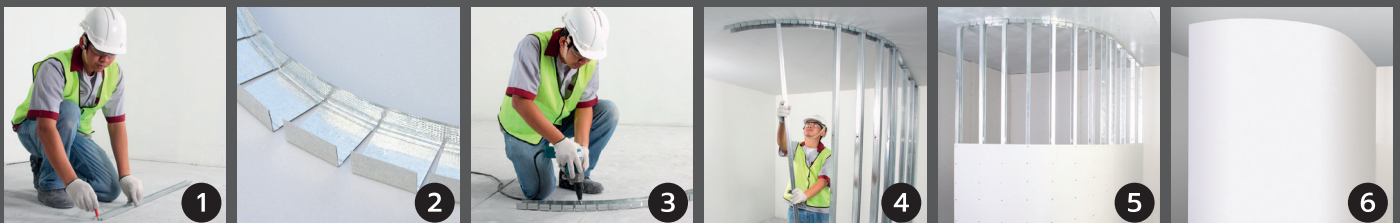

1. Mark the installation area of the curve partition on the floor and ceiling.
2. Prepare U Stud by cutting one side of the stud wing and bottom of the frame at every 5-10 cm space depends on diameter and radius of the curved partition.
3. Attach U Stud to the floor and ceiling by using screw at every 20 cm space. Attach more C Stud at every 20 cm space along the line starting from each side of stud ending for the covered area.
4. Support more C stud vertically by leaving space between each frame following the specification. (The space between each frame is depending on curve partition diameter and the gypsum board bending process.) Fix the end of C stud to U stud by using screw.
5. Attach Elephant FlexBOARD to the frame by laying the board horizontally using black screw. Each screw will have less than 20 cm space between each other on every frame.
6. Cover the joint with cotton tape and coat with Elephant Jointing Compound.

* Horizontally bend is suggested for bending Elephant FlexBOARD as it is stronger and more durable.



Bendable Gypsum Board Elephant FlexBOARD

Installing FlexBOARD with regular standard gypsum board.

The partition with 2 layers of Elephant FlexBOARD 6 mm can be harmoniously installed with regular gypsum partition that use 12 mm standard type gypsum board. Make the partition surface look smooth, has fire resistant and sound protection as same as installing whole partition with standard gypsum board.

In case of installing 2 layers of gypsum board, install the second sheet over lapping with first sheet at least about a single frame distance. If the joints are in the same position, it may reduce the fire and sound protection capability.

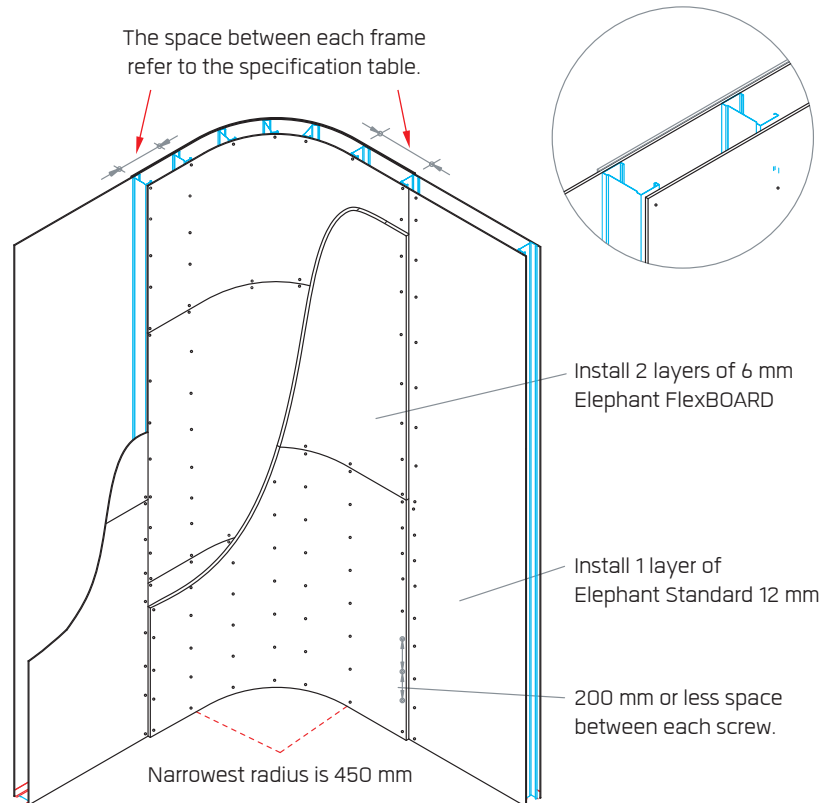

Specification table of bending radius and frame space

Curve radius (mm)	Space between each frame (mm)		
	Elephant FlexBOARD	Elephant Standard 9 mm	Elephant Standard 12 mm
450 – 600	150 w	–	–
600 – 900	150 d	–	–
900 – 1000	200 d	150 w	–
1000 – 1500	200 d	200 w	150 w
1500 – 2000	200 d	250 w	200 w
2000 – 2500	200 d	300 w	200 w
2500 – 3000	250 d	350 w	300 w
3000 – 4000	300 d	400 w	400 w

Remark : w = Gypsum Board Wet Bending (use water to wet the board before bending).
d = Gypsum Board Dry Bending

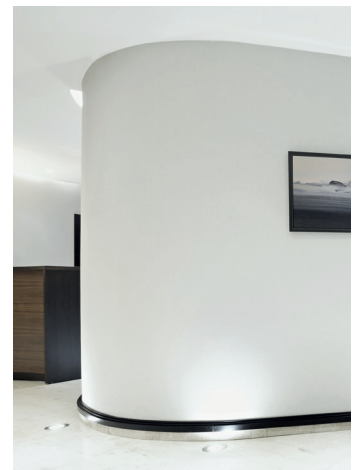

ELEPHANT
Gypsum Board

The Siam Gypsum Industry (Saraburi) Co., Ltd.

Pakin Building, 5th floor, 9 Ratchadapisek Road,
Dindang, Bangkok 10400 Tel. : (+66) 2-555-0000

A product of Knauf Group



www.siamgypsum.com/en_ex